

C-11, C-13(ss)·SC-12, SC-14(sus)/C-11K, C-13K(ss)·SC-12K, SC-14K(sus)

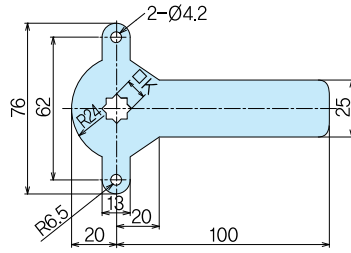

C-11



SC-14K

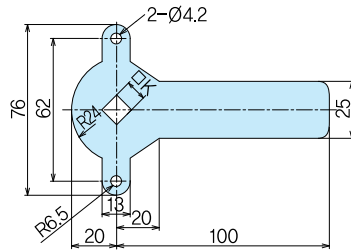

재 질 ●C-11 · C-13/철(SPHC)3.2t
●SC-12 · SC-14/스테인레스(SUS304)2t
표 면 처 리 ●C-11 · C-13/백색아연도금
Material ●C-11 · C-13/Hot rolled steel plate (SPHC) 3.2t
●SC-12 · SC-14/Stainless steel plate (SUS304) 2t
Fin ish ●C-11 · C-13/Plating

품번 Product No.		□K	중량(g) Weight		입수 Lot
SS	SUS		SS	SUS	
C-11	SC-12	8	88.4	88	50
C-13	SC-14	10	87.1	86	50
C-11K	SC-12K	8	88.4	88	50
C-13K	SC-14K	10	87.1	86	50

C-15~16(ss)·SC-15~16(sus)



SC-15

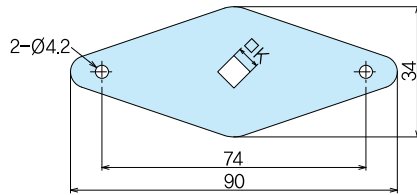

재 질 ●C-15~16/철(SPHC)3.2t
●SC-15~16/스테인레스(SUS304)3t
표 면 처 리 ●C-15~16/백색아연도금
Material ●C-15~16/Hot rolled steel plate (SPHC) 3.2t
●SC-15~16/Stainless steel plate (SUS304) 3t
Fin ish ●C-15~16/Plating

품번 Product No.		□K	중량(g) Weight		입수 Lot
SS	SUS		SS	SUS	
C-15	SC-15	8	45.5	42.8	50
C-16	SC-16	10	45.4	42.5	50

C-18~19(ss)·SC-18~19(sus)

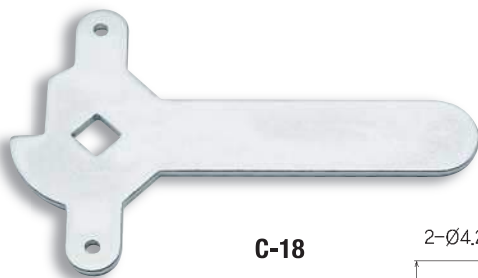

C-18

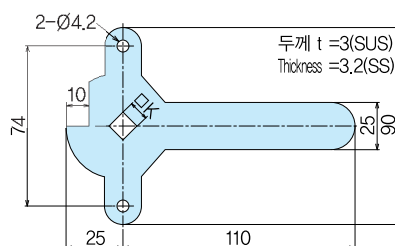

재 질 ●C-18~19/철 (SPHC) 3.2t
●SC-18/스테인레스 (SUS304) 3t
표 면 처 리 ●C-18~19/백색아연도금
Material ●C-18~19/Hot rolled steel plate (SPHC) 3.2t
●SC-15~16/Stainless steel plate (SUS304) 3t
Fin ish ●C-18~19/Plating

품번 Product No.		□K	중량(g) Weight		입수 Lot
SS	SUS		SS	SUS	
C-18	SC-18	10	103.6	98.7	50
C-19	SC-19	8	106.1	98	50