

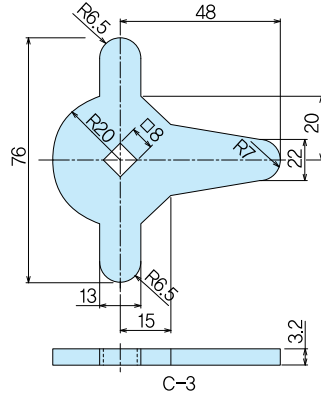

C-3

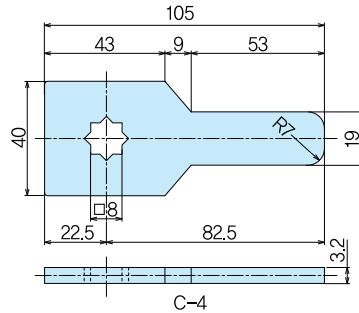

C-4



재 질 ●C-3·C-4/철(SPHC)3.2t
표면 처리 ●백색아연도금
Material ●C-3·C-4/Hot rolled steel plate (SPHC) 3.2t
Finish ●Plating

품번 Product No.	중량(g) Weight	입수 Lot
C-3	52	50
C-4	71	50

C-5~6(ss)·SC-6(sus)

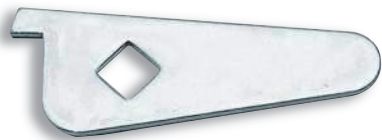

C-5

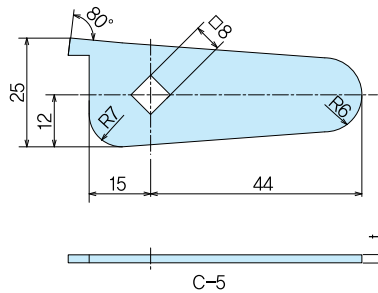

SC-6-2

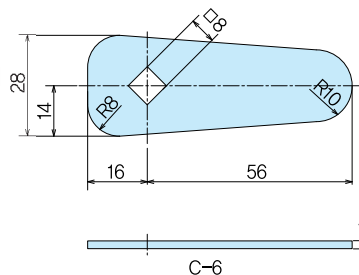

재 질 ●C-5/철(SPCC)2t
●C-6-2/철(SPCC)
●C-6-3/철(SPHC)
●SC-5/스테인레스(SUS304)2t
●SC-6/스테인레스(SUS304)
표면 처리 ●C-5·C-6/백색아연도금
Material ●C-5/Cold rolled steel plate (SPCC)2t
●C-6-2/Cold rolled steel plate (SPCC)
●C-6-3/Hot rolled steel plate (SPHC)
●SC-5/Stainless steel plate (SUS304)2t
●SC-6/Stainless steel plate (SUS304)
Finish ●C-5·C-6/Plating

품번 Product No.		t	중량(g) Weight		입수 Lot
SS	SUS		SS	SUS	
C-5		2	15		100
C-6-2	SC-6-2	2	24.4	23.4	100
C-6-3		3	37.8		100