

강력 마그네틱 캐치

MAGNETIC CATCHES



엑세서리

DMC-10



DMC-10-1



DMC-10-4

재질 ●마그네트/Ba-페라이트(양극성) 케이스/아연합금(ZDC)
 표면처리 ●케이스/니켈도금(MZNi)
 용도 ●배전반, 분전반, 공작기계

Material ●Magnet/Ba-ferrite(anisotropy)Case/Znic alloy (ZDC)
 Finish ●Case/Nickel plating (MZNi)
 Specific Use ●Distribution boards, machine tools

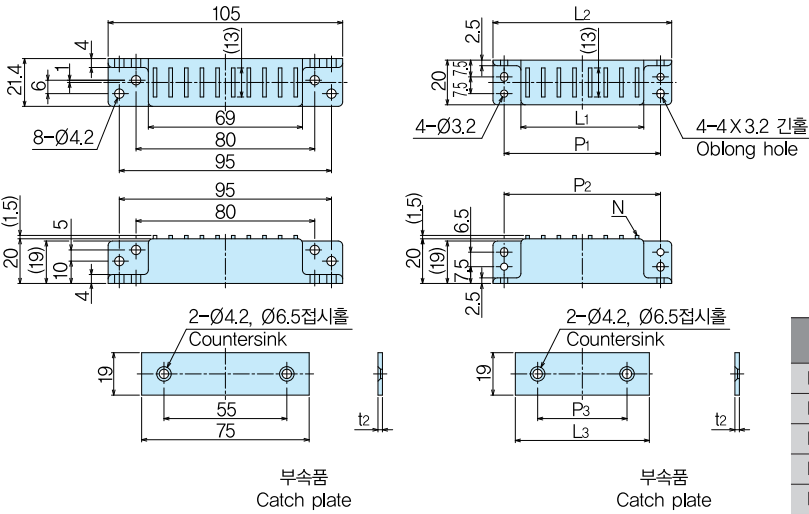

품번 Product No.	L1	L2	L3	P1	P2	P3	N	흡착력 (kgf)	중량(g) Weight
DMC-10-1	69	105	75	도면 참조	참조	55	10	15	206
DMC-10-2	55	80	60	70	70	40	8	14	140
DMC-10-3	41	61	43	50	50	27	6	11	110
DMC-10-4	27	50	29	40	40	18	4	7	74
DMC-10-5	20	40	22	30	30	12	3	3	56

DMC-11



DMC-11S

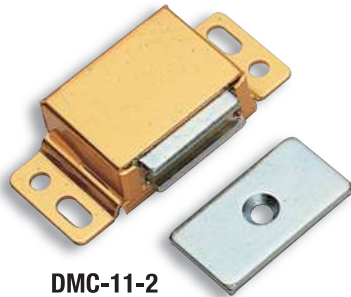

DMC-11-2

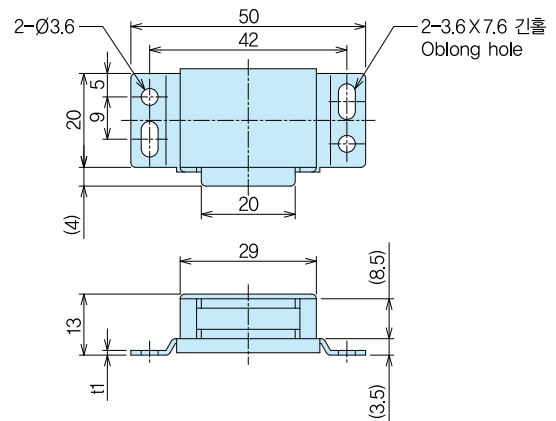

품번 Product No.	본체(케이스) Main body(Case)		흡착력(kgf) Adsorption	부속품 Catch plate			중량(g) Weight
	재질 Material	표면처리 Finish		품번 Product No.	재질 Material	표면처리 Finish	
DMC-11-2	AIP	금색 양은 Alumite treatment (Gold)	3.2	MC-1106	SPCC	UZn	37
DMC-11S	AIP	갈색금속도장 Metallic finish (Brown)	5.9	MC-1106	SPCC	Cr	37
표준세트수 Standard set Q'ty	1			1			

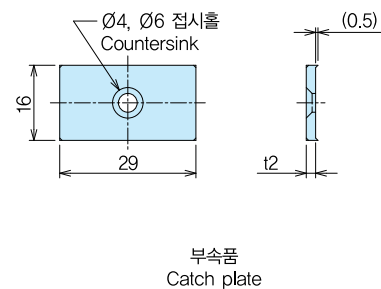

부속품
Catch plate

캐치