



**BN-3-10**



**SBN-5-6**

BN-1~3

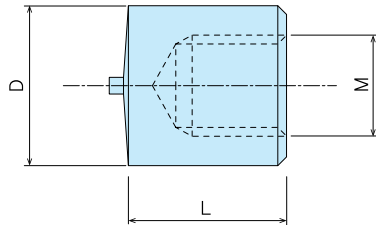

BN-4~5

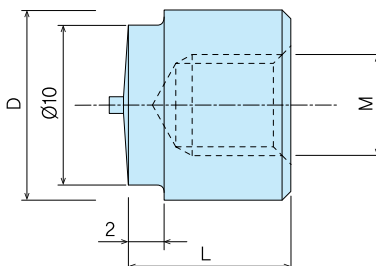

특징	● 스트레이트형
Feature	● Various saizes
재질	● BN-/철틈(SS) ● SBN-/스테인레스(SUS304) ● BNA-/알루미늄(A1050)
표면처리	● BN-/동도금
Material	● BN-/Rolled steel(SS) ● SBN-/Stainless steel(SUS304) ● BNA-/Alumimum(A1050)
Finish	● BN-/Copper plating
Remarks	● Various sizes are available for special ordered products.

품번 Product No.			Size D x L x M	유효깊이 Effective depth	중량(g) Weight		
SS	SUS	AL			SS	SUS	AL
BN-1-1	SBN-1-1		6X5XM3	3	1	1	
BN-1-2	SBN-1-2		6X6XM3	4	1.2	1.2	
BN-1-2L			6X6.6XM3	4	1.2		
BN-1-3	SBN-1-3		6X7XM3	4	1.2	1.2	
BN-1-4	SBN-1-4	BNA-1-4	6X8XM3	5	1.4	1.4	0.6
BN-1-5	SBN-1-5		6X9XM3	6	1.6	1.6	
BN-1-6	SBN-1-6		6X10XM3	7	1.8	1.8	
BN-1-7	SBN-1-7	BNA-1-7	6X12XM3	8	2.2	2.2	0.8
BN-1-8	SBN-1-8		6X15XM3	8	2.6	2.8	
BN-1-9	SBN-1-9		6X20XM3	8	3.6	3.8	
BN-2-1	SBN-2-1		8X8XM4	5	2.6	2.6	
BN-2-2	SBN-2-2	BNA-2-2	8X10XM3	6	3.6	3.6	1.4
BN-2-3	SBN-2-3	BNA-2-3	8X10XM4	6	3.2	3.4	1.2
BN-2-3L			8X12XM4	8	3.8		
BN-2-4	SBN-2-4	BNA-2-4	8X10XM5	6	3	2.8	1
BN-2-5	SBN-2-5	BNA-2-5	8X15XM3	9	5.4	5.2	2
BN-2-6	SBN-2-6	BNA-2-6	8X15XM4	9	4.8	4.8	1.8
BN-2-7	SBN-2-7	BNA-2-7	8X15XM5	9	4.2	4.2	1.6
BN-2-8	SBN-2-8		8X20XM4	11	6.4	6.6	
BN-2-9	SBN-2-9		8X20XM5	11	6	5.8	
BN-2-10	SBN-2-10		8X25XM4	12	7.6	8.4	
BN-3-1	SBN-3-1	BNA-3-1	10X10XM4	6	5.6	5.6	2
BN-3-2	SBN-3-2	BNA-3-2	10X10XM5	6	5.2	5	1.8
BN-3-3	SBN-3-3	BNA-3-3	10X10XM6	6	4.8	4.6	1.6
BN-3-4	SBN-3-4		10X12XM5	8	6.2	6	
BN-3-5	SBN-3-5		10X12XM6	8	5.6	5.6	
BN-3-6	SBN-3-6	BNA-3-6	10X15XM4	10	8.2	8.2	2.8
BN-3-7	SBN-3-7	BNA-3-7	10X15XM5	10	7.6	7.6	2.6
BN-3-8	SBN-3-8	BNA-3-8	10X15XM6	10	6.8	6.8	2.4
BN-3-9	SBN-3-9	BNA-3-9	10X20XM5	11	10	10.2	3.4
BN-3-10	SBN-3-10	BNA-3-10	10X20XM6	11	9	9.6	3.2
BN-4-1	SBN-4-1	BNA-4-1	12X10XM4	6	7.8	7.6	2.6
BN-4-2	SBN-4-2	BNA-4-2	12X10XM5	6	7.4	7.2	2.6
BN-4-3	SBN-4-3	BNA-4-3	12X10XM6	6	6.8	6.8	2.4
BN-5-1	SBN-5-1		16X10XM6	5	13.4	12.4	
BN-5-2	SBN-5-2		16X10XM8	5	11	11.2	
BN-5-3	SBN-5-3		16X15XM6	8	19.8	19.4	
BN-5-4	SBN-5-4		16X15XM8	8	18.2	17.4	
BN-5-5	SBN-5-5		16X20XM6	11	26.6	26.8	
BN-5-6	SBN-5-6		16X20XM8	11	24.4	24.2	