

가스단파 · 쇼바브라켓

GAS DANPPERS

C-300



재 질 ● 손잡이부-STKM, 봉-S45C
표 면 처 리 ● 손잡이부-열처리 보장, 봉-크롬도금
Material ● Rolled steel (SS400)
F i n i s h ● Trivalent chromate plating

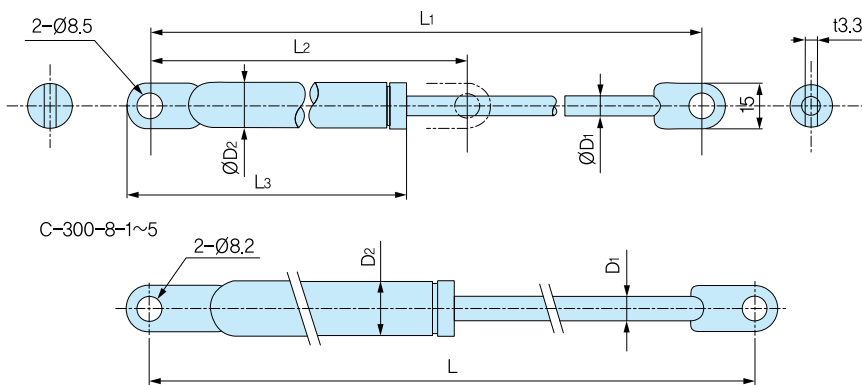

품번 Product No.	L1	L2	L3	ØD1	ØD2	가스반발력(kgf)
C-300-1-1	627	384	375	12.5	22	44
C-300-1-2	472	330	315	10	22	28
C-300-1-3	412	265	255	10	22	15
C-300-1-4	364	264	210	10	22	40
C-300-1-5	279	199	190	10	22	25
C-300-2-1	281	181	165	6	15	7
C-300-3-1	261	171	160	6	15	8
C-300-4-1	181	131	115	6	15	8

품번 Product No.	L1	ØD1	ØD2
C-300-8-1	280	8	18
C-300-8-2	365	8	18
C-300-8-3	500	8(10)	18(22)
C-300-8-4	600	10	22
C-300-8-5	760	10	22

C-300-BKT

재 질 ● SPHC, SUS
표 면 처 리 ● SPHC-백색아연도금, SUS-바렐연마
Material ● SPHC, SUS
F i n i s h ● Trivalent chromate plating

